

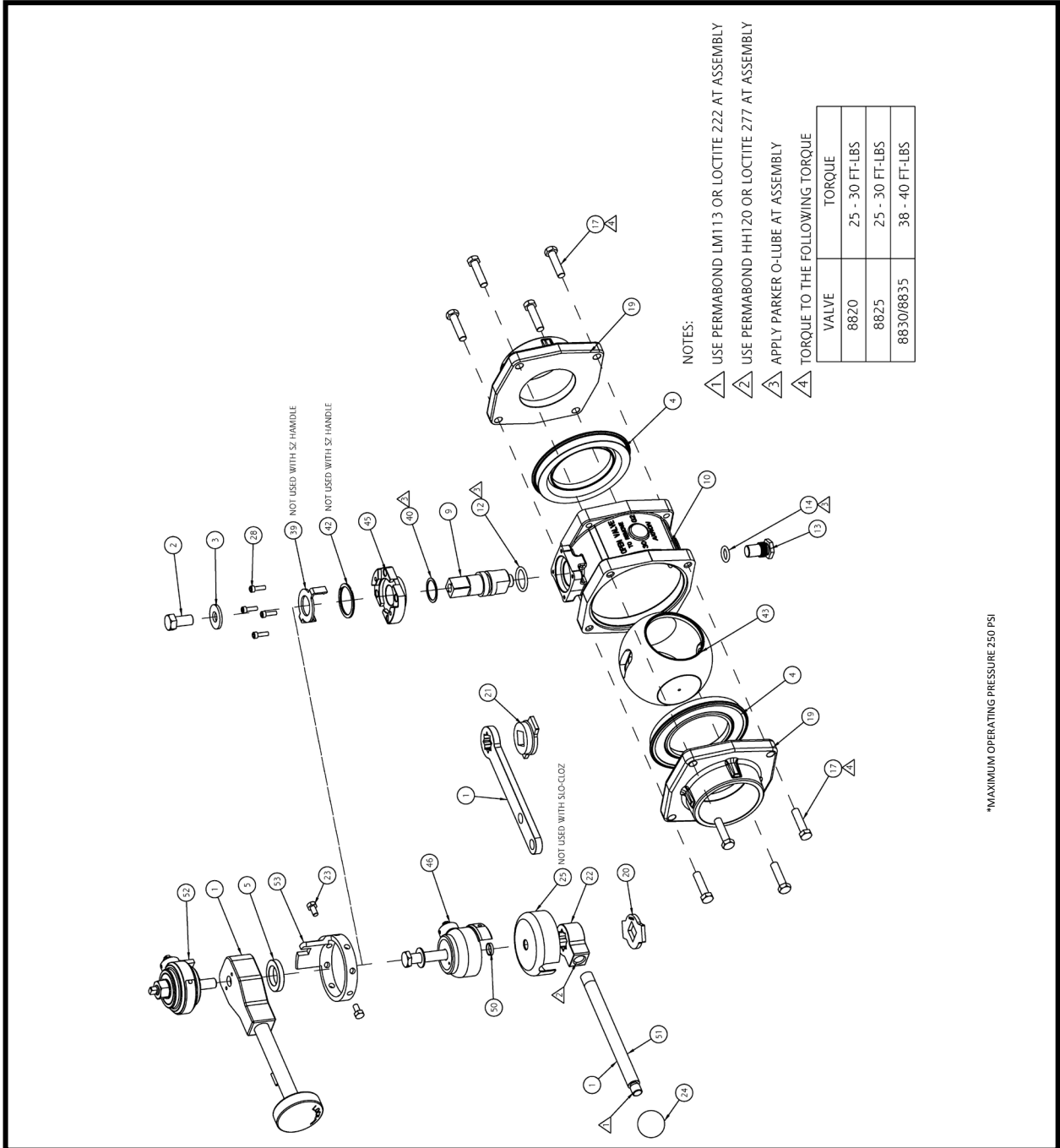

**STYLE 8820-8835 GENERATION II HEAVY DUTY SWING-OUT™ VALVE  
 SELF-LOCKING WITH METAL BALL  
 TECHNICAL SERVICE PARTS**



\*MAXIMUM OPERATING PRESSURE 250 PSI

PHONE: 800.228.1161 | WEBSITE: [www.akronbrass.com](http://www.akronbrass.com)



**STYLE 8820-8835 GENERATION II HEAVY DUTY SWING-OUT™  
VALVE SELF-LOCKING WITH METAL BALL  
TECHNICAL SERVICE PARTS**

| FIND | DESCRIPTION | QTY                                   | ITEM |          |          |          |          |
|------|-------------|---------------------------------------|------|----------|----------|----------|----------|
|      |             |                                       | 8820 | 8825     | 8830     | 8835     |          |
| 1    | -           | HANDLE R-1 STANDARD LENGTH            | 1    | 721237   | 721238   | 721238   | 721238   |
| 1    | -           | TS HANDLE ASSEMBLY - 9"               | 1    | 78250563 | 78250563 | 78250563 | 78250563 |
| 1    | -           | TSC HANDLE ASSEMBLY - 9"              | 1    | 78250565 | 78250565 | 78250565 | 78250565 |
| 1    | -           | SZ HANDLE ASSEMBLY - 9"               | 1    | 86303002 | 86303002 | 86303002 | 86303002 |
| 2    | -           | BOLT, ½"-13 x 1"                      | 1    | 761045   | 761045   | 761045   | 761045   |
| 2    | -           | BOLT (SZ HANDLE ONLY), ½"-13 x 1.25"  | -    | 765125   | 765125   | 765125   | 765125   |
| 3    | -           | WASHER                                | 1    | 784120   | 784120   | 784120   | 784120   |
| 4    | C           | SEAT                                  | 2    | 769561   | 769537   | 769181   | 769181   |
| 5    | F           | BRAKE WASHER (SZ HANDLE)              | 1    | 784213   | 784213   | 784213   | 784213   |
| 9    | -           | BALL TRUNNION                         | 1    | 772262   | 772262   | 772263   | 772263   |
| 10   | -           | BODY                                  | 1    | 122026   | 122027   | 122028   | 122028   |
| 12   | C           | O-RING 2 - 214                        | 1    | 757010   | 757010   | 757010   | 757010   |
| 13   | -           | THREADED TRUNNION                     | 1    | 773094   | 773094   | 773095   | 773095   |
| 14   | C           | O-RING                                | 1    | 757198   | 757198   | 757217   | 757217   |
| 17   | -           | BOLT (FLANGE)                         | 8    | 761092   | 761048   | 761058   | 761058   |
| 19   | D           | VALVE ADAPTER                         | 2    | -        | -        | -        | -        |
| 20   | -           | STOP PLATE (TS/TSC HANDLE)            | 1    | 742073   | 742073   | 742073   | 742073   |
| 21   | -           | STOP PLATE (R-1 HANDLE)               | 1    | 742095   | 742095   | 742095   | 742095   |
| 22   | -           | HANDLE HUB (TS/TSC HANDLE)            | 1    | 721278   | 721278   | 721278   | 721278   |
| 23   | G           | SCREW (SLO-CLOZ SZ HANDLE)            | 2    | -        | -        | 761050   | 761050   |
| 24   | -           | BALL (TS/TSC HANDLE)                  | 1    | 703080   | 703080   | 703080   | 703080   |
| 25   | -           | COVER (TSC HANDLE)                    | 1    | 109177   | 109177   | 109177   | 109177   |
| 28   | -           | SCREW (BONNET)                        | 4    | 765028   | 765028   | 765028   | 765028   |
| 39   | -           | BEARING BRAKE                         | 1    | 704788   | 704788   | 704788   | 704788   |
| 40   | -           | TRUNNION BEARING (GEN 2)              | 1    | 703925   | 703925   | 703925   | 703925   |
| 42   | -           | WAVE SPRING                           | 1    | 768291   | 768291   | 768291   | 768291   |
| 43   | C           | BALL (GEN 2)                          | 1    | 803040   | 803132   | 703933   | 703933   |
| 45   | H           | BONNET                                | 1    | 703806   | 703806   | 703806   | 703806   |
| 46   | -           | SLO-CLOZ ASSEMBLY (R-1 AND SZ HANDLE) | 1    | 78750001 | 78750001 | 78750001 | 78750001 |
| 51   | -           | RODS (TS/TSC HANDLE) STD              | 1    | 109146   | 109146   | 109146   | 109146   |
| 52   | -           | SLO-CLOZ ASSEMBLY (SZ HANDLE)         | 1    | -        | -        | 76750004 | 76750004 |
| 53   | G           | COLLAR (SLO-CLOZ SZ HANDLE)           | 1    | -        | -        | 707958   | 707958   |

**COMPONENT PARTS OF ADAPTERS NOT ILLUSTRATED**

|   |      |                       |   |        |        |        |        |
|---|------|-----------------------|---|--------|--------|--------|--------|
| - | -    | ADAPTER PLUG          | - | 744018 | 744018 | 744018 | 744018 |
| - | -    | ADAPTER SWIVEL GASKET | - | 714013 | 714019 | 714022 | 714023 |
| - | -    | SCREEN                | - | -      | 769027 | 769241 | 769241 |
| - | A, B | BALL BEARING          | - | 42     | 38     | 47     | 53     |
| - | -    | ¼" ADAPTER/BODY PLUG  | - | 744011 | 744011 | 744011 | 744011 |
| - | E    | SWIVEL (NH) - CHROME  | - | 119451 | 117847 | 100066 | 100067 |
| - | -    | SWIVEL PLUG           | - | 765008 | 742023 | 742023 | 742023 |

| FIND | DESCRIPTION   | ITEM   |
|------|---|--------|
| A    | KIT OF 50 BALLS, FOR 2 ½ - 3 ½"   | 109041 |
| B    | KIT OF 50 BALLS, FOR 2"   | 109042 |
| C    | PARTS IN SERVICE KITS   | -      |
| D    | SEE CURRENT CATALOG FOR COMPLETE LIST   | -      |
| E    | FOR OTHER THREADS ORDER BY DESCRIPTION AND THREAD SIZE (ODM AND TPI) OR BY THREAD CODE  | -      |
| F    | USED WITH SZ HANDLE ONLY IN PLACE OF ITEMS 39 AND 42 - INCLUDED WITH SZ HANDLE ASSEMBLY | -      |
| G    | INCLUDED IN SLO-CLOZ ASSEMBLY (SZ HANDLE) - ITEM 52                                     | -      |
| H    | USE 122888, FOR 8630/8635 WITH SZ HANDLE  | -      |

WARRANTY AND DISCLAIMER: We warrant Akron Brass products for a period of five (5) years\* after purchase against defects in materials or workmanship. Akron Brass will repair or replace product which fails to satisfy this warranty. Repair or replacement shall be at the discretion of Akron Brass. Products must be promptly returned to Akron Brass for warranty service. We will not be responsible for wear and tear, any improper installation, use, maintenance or storage; negligence of the owner or user; repair or modification after delivery; failure to follow our instructions or recommendations; or anything else beyond our control. WE MAKE NO WARRANTIES, EXPRESS OR IMPLIED, OTHER THAN THOSE INCLUDED IN THIS WARRANTY STATEMENT, AND WE DISCLAIM ANY IMPLIED WARRANTY OF MERCHANTABILITY OR FITNESS FOR ANY PARTICULAR PURPOSE. Further, we will not be responsible for any consequential, incidental or indirect damages (including, but not limited to, any loss of profits) from any cause whatsoever. No person has authority to change this warranty. Unless otherwise provided herein, Akron Brass industrial electronic components & the Severe-Duty Monitor have a one (1) year warranty. Select Akron Brass handline nozzles and valves carry a ten (10) year warranty. Weldon products have a two (2) year warranty from date of manufacture (excluding consumable components). Select Weldon LED products carry a five (5) year warranty. Honda products have the manufacturers' warranty and Akron Brass disclaims any warranty in respect of those products.